

PRELIMINARY - NOT FOR CONSTRUCTION

STATE OF MAINE
DEPARTMENT OF TRANSPORTATION
16710.00
PIN
ME 3641 NH 251/108 16710.00
ROADWAY PLANS

PROJ. MANAGER	DATE	BY	DATE
W. BRADLEE	06-30-14	B. LYON	06-30-14
CHECKED/REVIEWED		S. SAWYER	06-30-14
REVISIONS 1			
REVISIONS 2			
REVISIONS 3			
REVISIONS 4			
REVISIONS 5			
REVISIONS 6			
REVISIONS 7			
REVISIONS 8			

SIGNATURE	P.E. NUMBER	DATE

SARAH MILDRED LONG BRIDGE
PISCATAQUA RIVER
KITTERY, ME
PORTSMOUTH, NH
CROSS SECTIONS

SHEET NUMBER
R57
OF R104



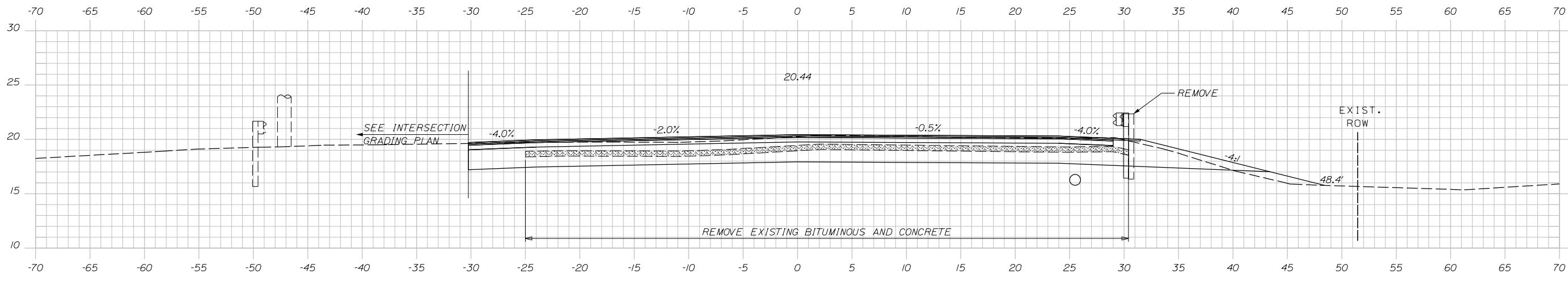

213+75.00

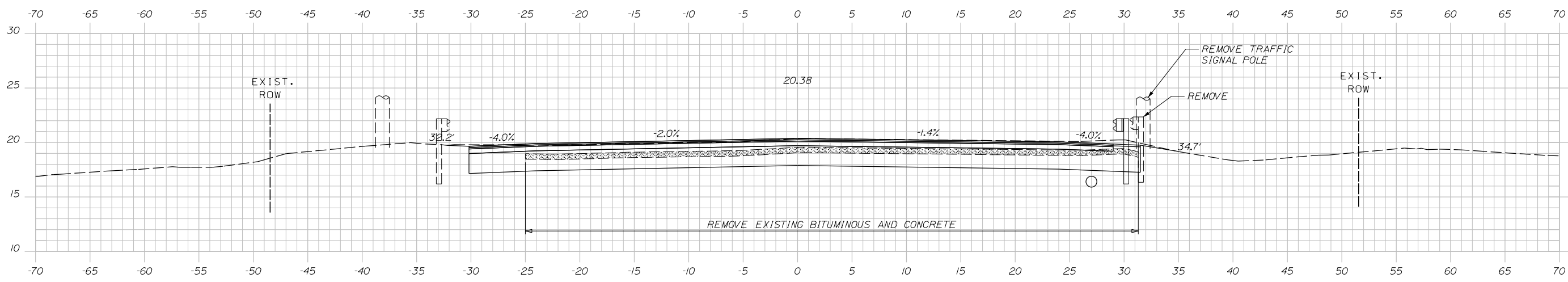

213+50.00

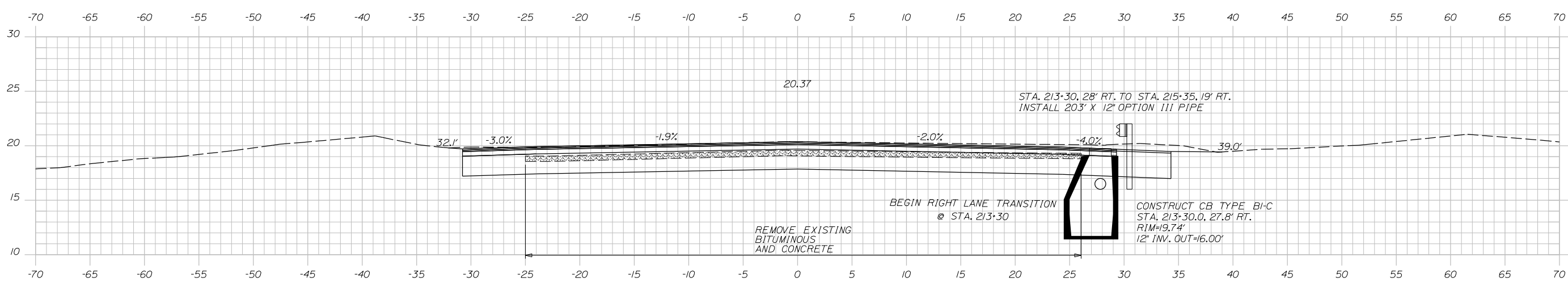

213+30.00

PRELIMINARY - NOT FOR CONSTRUCTION

STATE OF MAINE
DEPARTMENT OF TRANSPORTATION
16710.00
PIN
ME 3641 NH 251/108 16710.00
ROADWAY PLANS

PROJ. MANAGER	W. BRADLEE	DATE
DESIGN-DETAILED	B. LYON	06-30-14
CHECKED-REVIEWED	S. SAWYER	06-30-14
REVISIONS		
REVISIONS 2		
REVISIONS 3		
REVISIONS 4		
REVISIONS 5		
REVISIONS 6		
REVISIONS 7		
REVISIONS 8		

SIGNATURE	P.E. NUMBER	DATE

SARAH MILDRED LONG BRIDGE
PISCATAQUA RIVER
PORTSMOUTH, NH
KITTERY, ME
CROSS SECTIONS

SHEET NUMBER
R58
OF R104



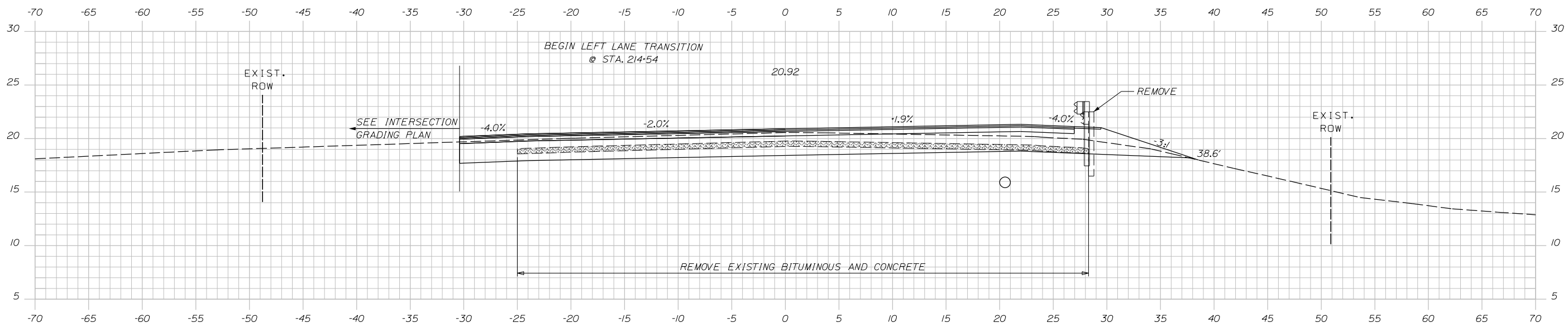

214+50.00

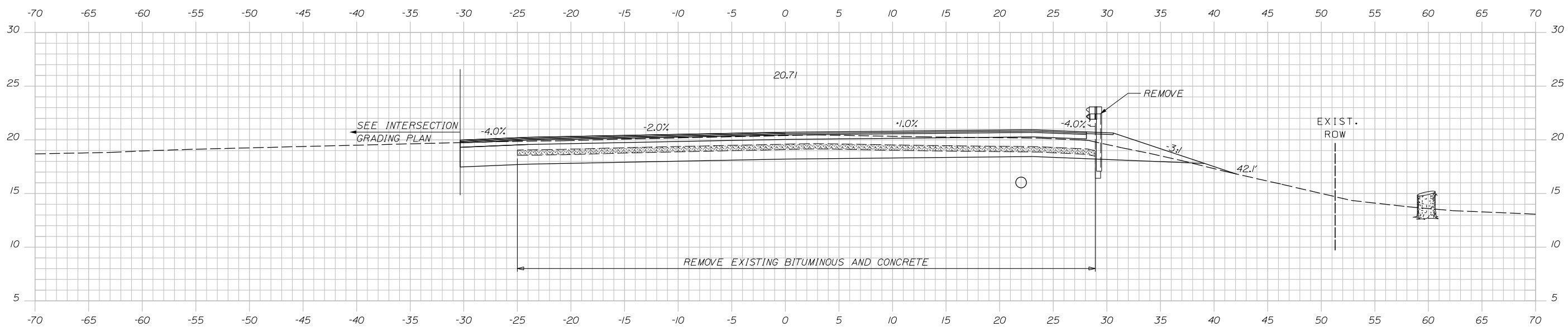

214+25.00

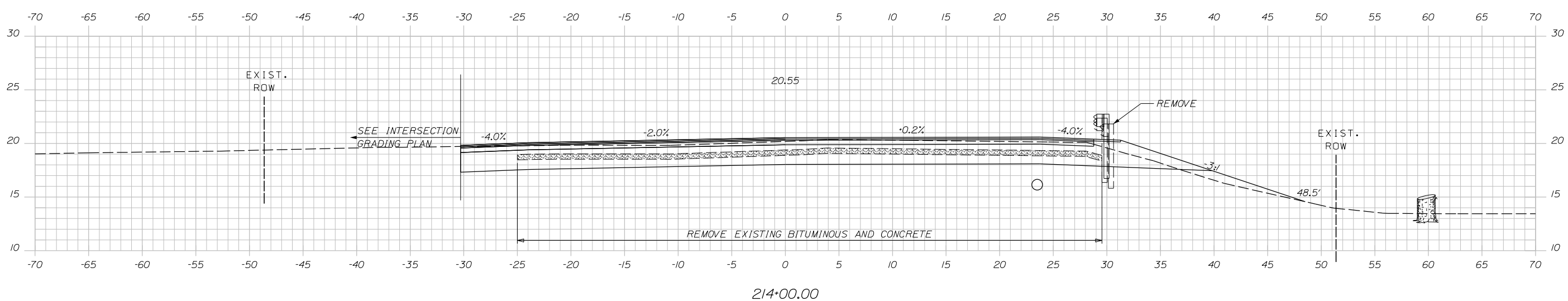

214+00.00

PRELIMINARY - NOT FOR CONSTRUCTION

STATE OF MAINE
DEPARTMENT OF TRANSPORTATION
16710.00
PIN
ME 3641 NH 251/108 16710.00
ROADWAY PLANS

PROJ. MANAGER	DATE	BY	SIGNATURE
W. BRADLEE	06-30-14	B. LYON	
CHECKED/REVIEWED	06-30-14	S. SAWYER	
REVISIONS			
REVISIONS 2			
REVISIONS 3			
REVISIONS 4			
REVISIONS 5			
REVISIONS 6			
REVISIONS 7			
REVISIONS 8			

SARAH MILDRED LONG BRIDGE
PISCATAQUA RIVER
PORTSMOUTH, NH
KITTEERY, ME

CROSS SECTIONS

SHEET NUMBER
R59
OF R104



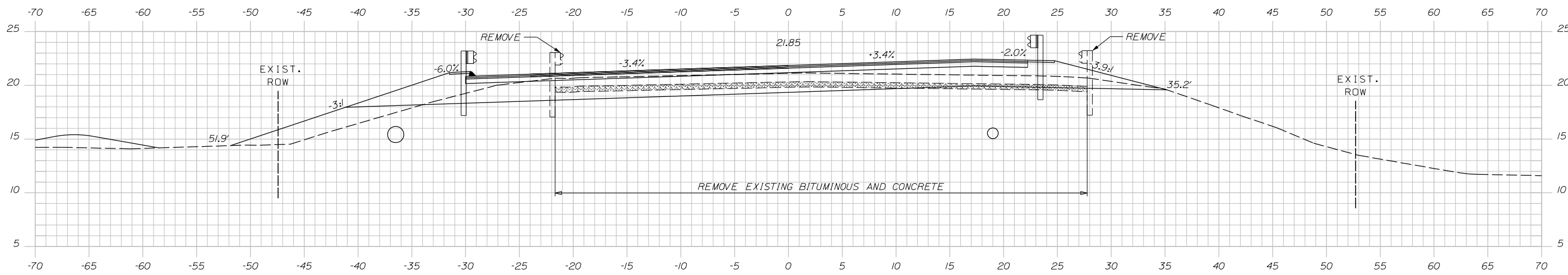

215+25.00

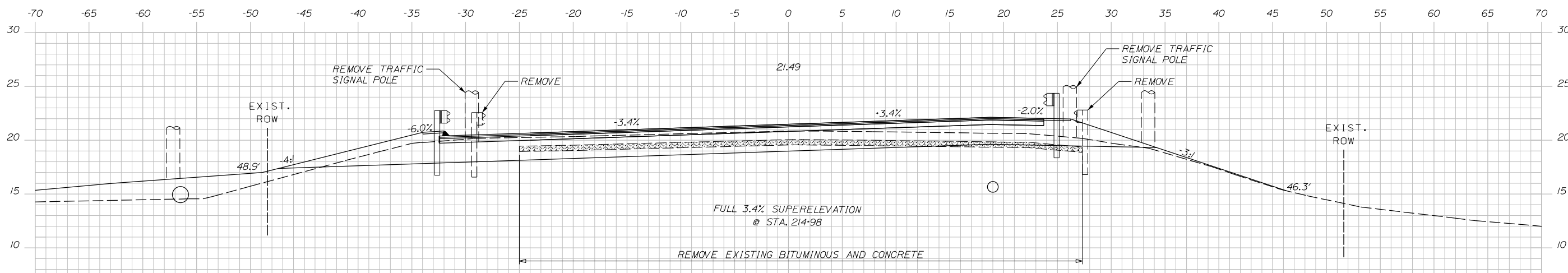

215+00.00

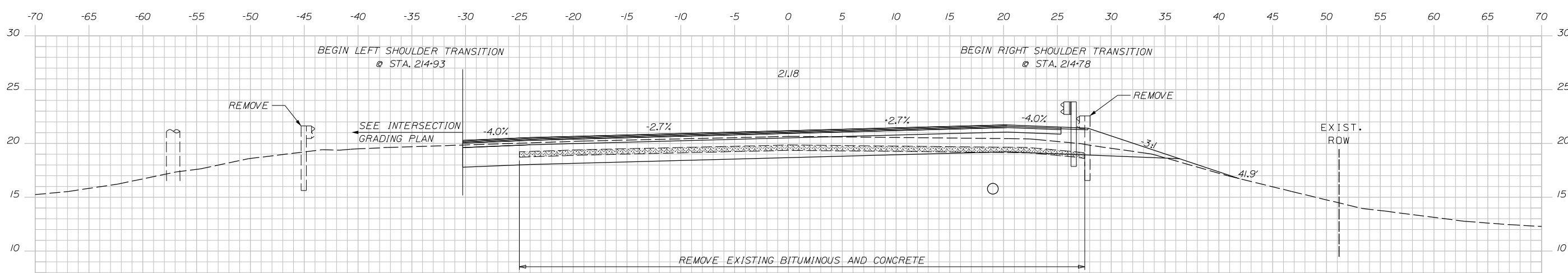

214+75.00

PRELIMINARY - NOT FOR CONSTRUCTION

STATE OF MAINE
DEPARTMENT OF TRANSPORTATION
16710.00

ME 3641 NH 251/108
PIN 16710.00
ROADWAY PLANS

PROJ. MANAGER: W. BRADLEE
DESIGN-DETAILED: B. LYON
CHECKED-REVIEWED: S. SAWYER
SIGNATURE: _____
P.E. NUMBER: _____
DATE: _____

DATE	BY	REVISIONS
06-30-14	B. LYON	REVISIONS 1
06-30-14	S. SAWYER	REVISIONS 2
		REVISIONS 3
		REVISIONS 4
		REVISIONS 5
		REVISIONS 6
		REVISIONS 7
		REVISIONS 8

SARAH MILDRED LONG BRIDGE
PISCATAQUA RIVER
PORTSMOUTH, NH
KITTERY, ME

CROSS SECTIONS

SHEET NUMBER

R60
OF R104



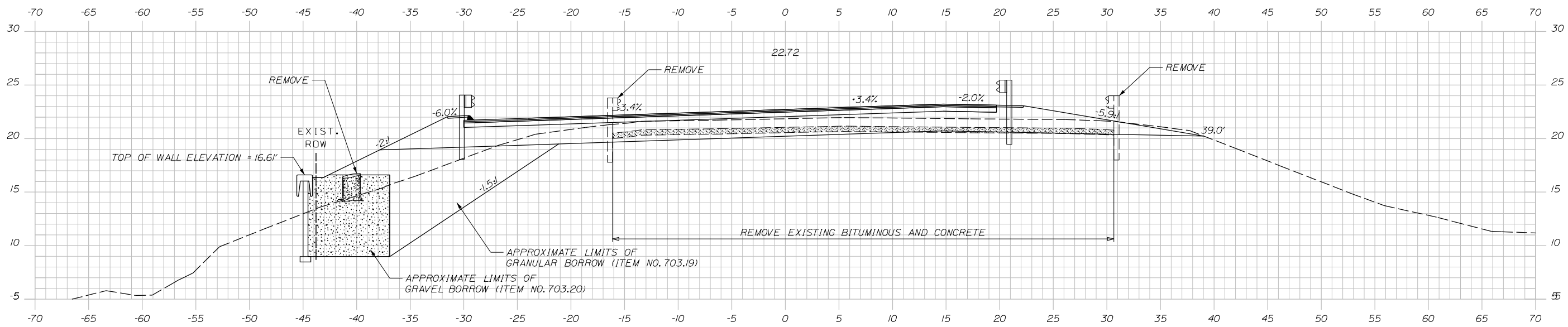

215+75.00

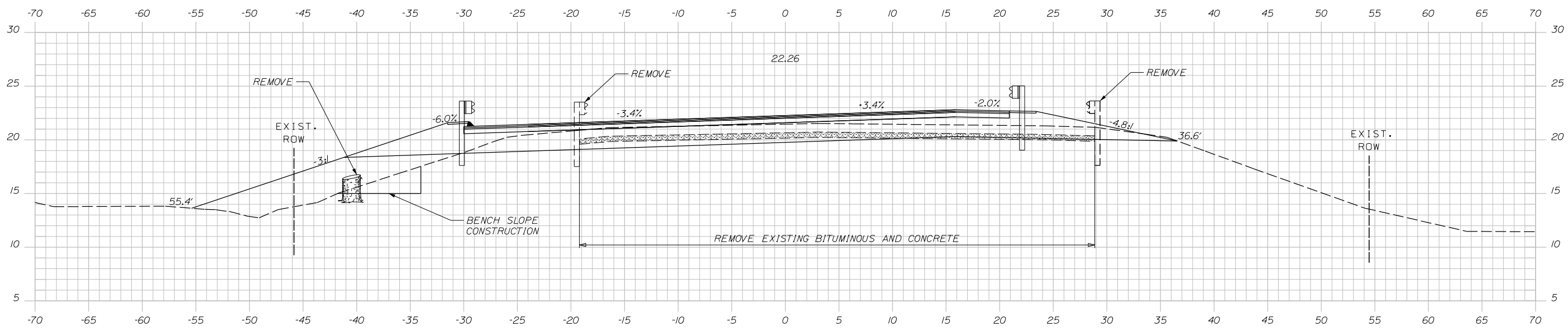

215+50.00

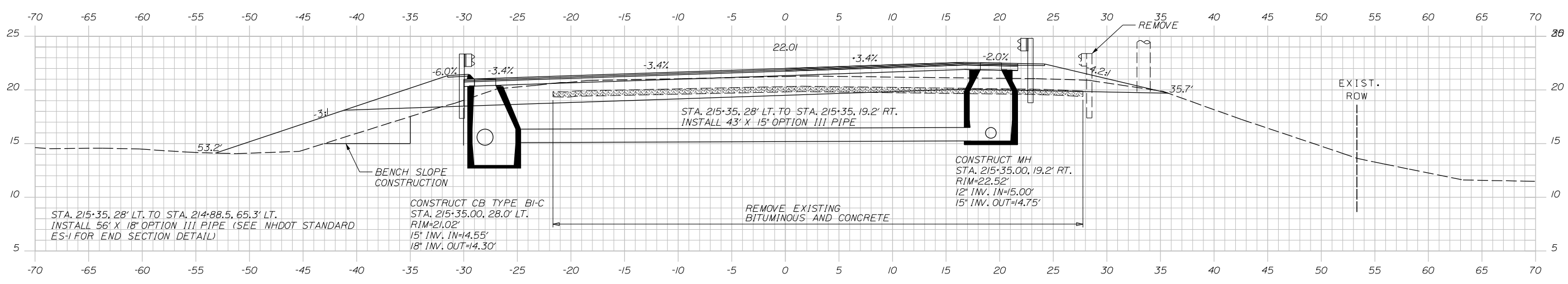

215+35.00

PRELIMINARY - NOT FOR CONSTRUCTION

STATE OF MAINE
 DEPARTMENT OF TRANSPORTATION
 16710.00
 PIN
 ME 3641 NH 251/108 16710.00
 ROADWAY PLANS

PROJ. MANAGER	DATE	BY	SIGNATURE
W. BRADLEE	06-30-14	B. LYON	
CHECKED/REVIEWED	06-30-14	S. SAWYER	

REVISIONS	P.E. NUMBER	DATE
REVISIONS 1		
REVISIONS 2		
REVISIONS 3		
REVISIONS 4		
REVISIONS 5		
REVISIONS 6		
REVISIONS 7		
REVISIONS 8		

SARAH MILDRED LONG BRIDGE
 PISCATAQUA RIVER
 PORTSMOUTH, NH
 KITTERY, ME
 CROSS SECTIONS

SHEET NUMBER

R61
 OF R104



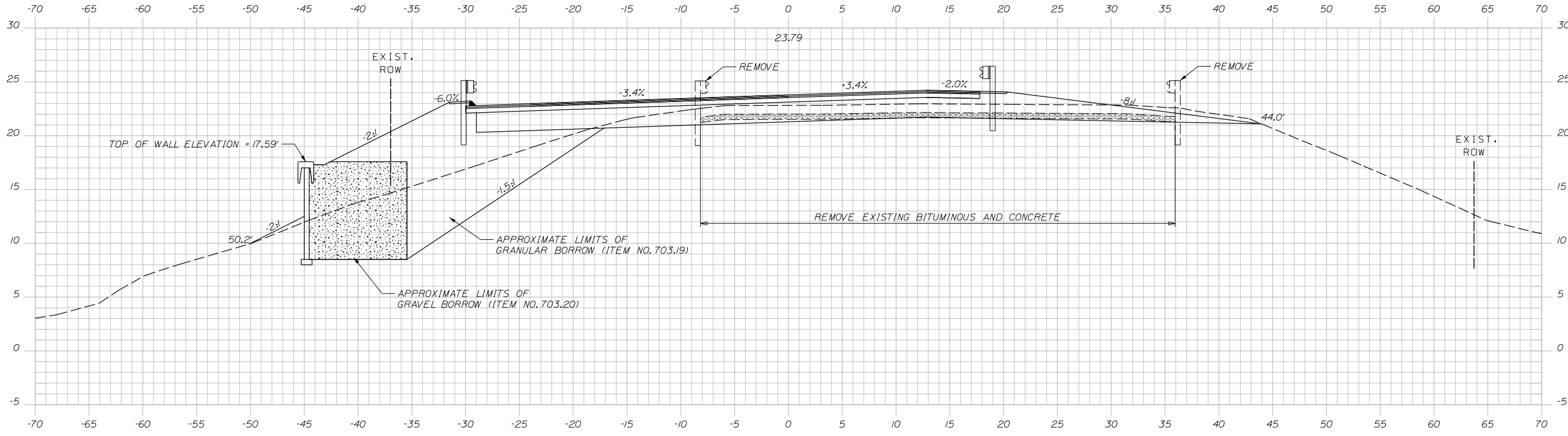

216+25.00

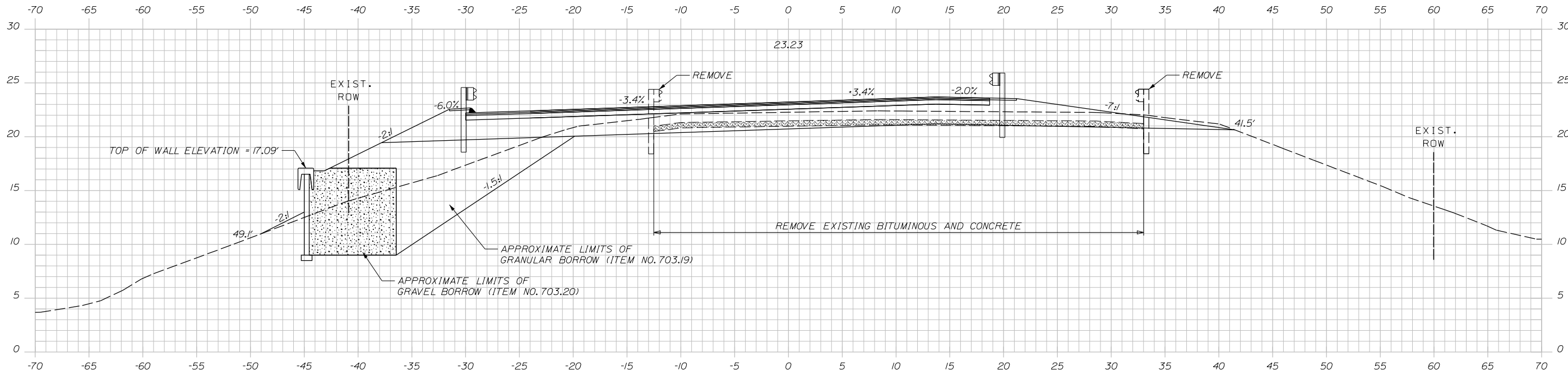

216+00.00

PRELIMINARY - NOT FOR CONSTRUCTION

STATE OF MAINE
DEPARTMENT OF TRANSPORTATION
16710.00

ME 3641 NH 251/108
PIN 16710.00
ROADWAY PLANS

SIGNATURE
P.E. NUMBER
DATE

DATE	BY
06-30-14	B. LYON
06-30-14	S. SAWYER

SARAH MILDRED LONG BRIDGE
PISCATAQUA RIVER
KITTERY, ME
PORTSMOUTH, NH
CROSS SECTIONS

SHEET NUMBER
R62
OF R104



100% PLANS (7-3-2014)

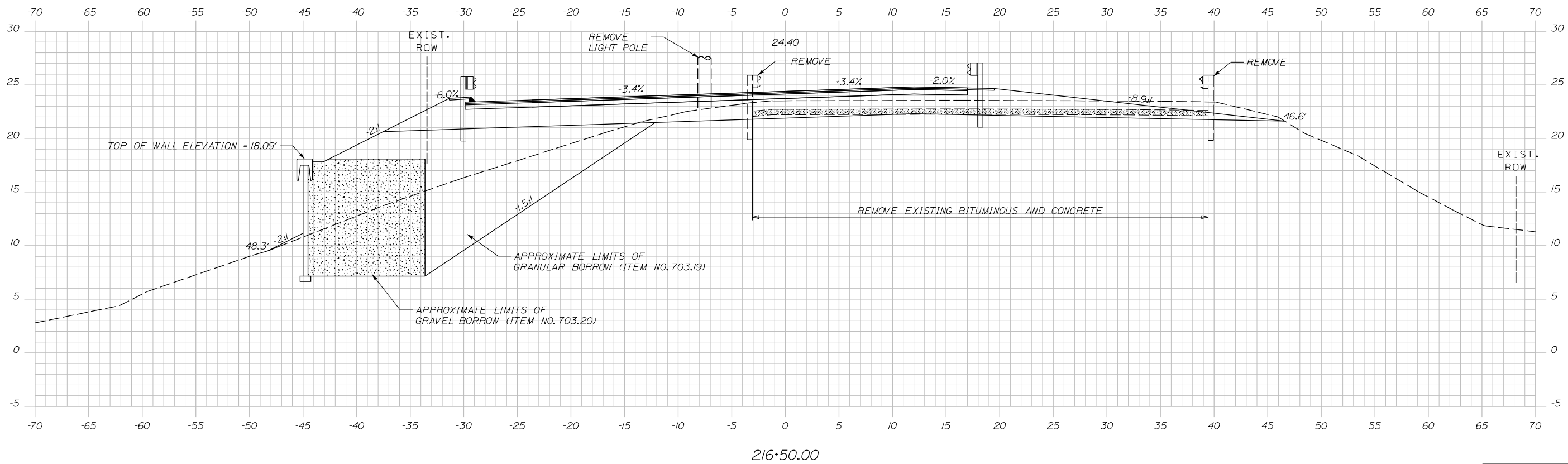
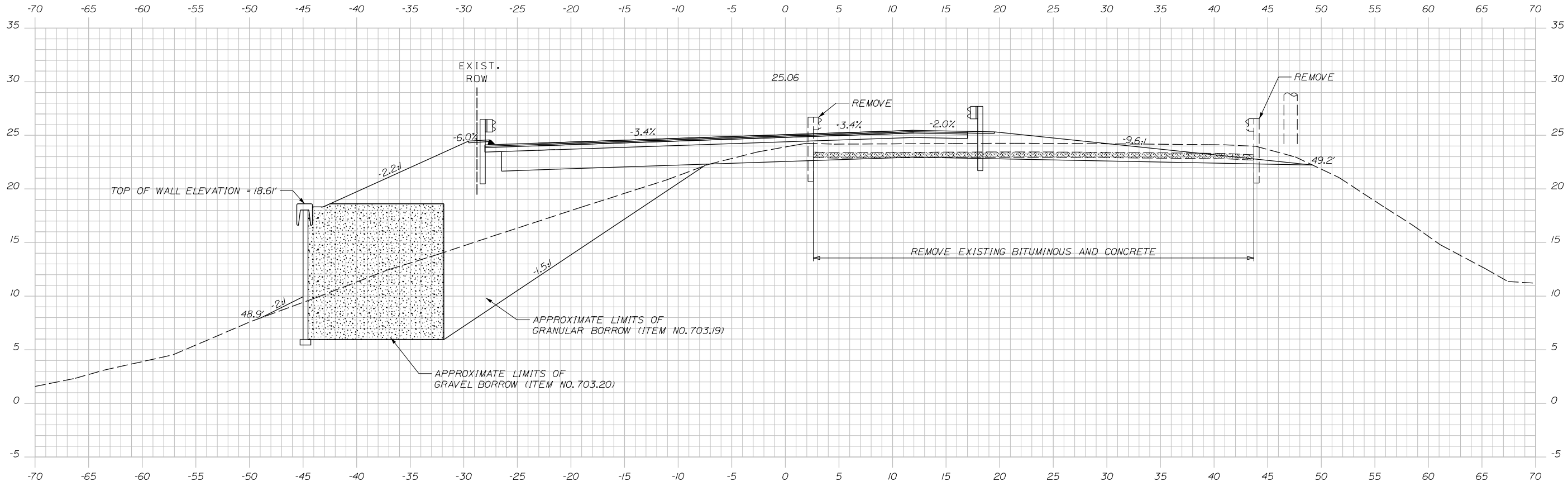

PRELIMINARY - NOT FOR CONSTRUCTION

STATE OF MAINE
DEPARTMENT OF TRANSPORTATION
16710.00

SIGNATURE
P.E. NUMBER
DATE

PROJECT MANAGER
DESIGN-DETAILED BY
CHECKED-REVIEWED BY
REVISIONS 1
REVISIONS 2
REVISIONS 3
REVISIONS 4
REVISIONS 5
REVISIONS 6
REVISIONS 7
REVISIONS 8

SARAH MILDRED LONG BRIDGE
PISCATAQUA RIVER
PORTSMOUTH, NH
KITTEERY, ME

CROSS SECTIONS
SHEET NUMBER
R63
OF R104



ROADWAY PLANS
PIN 16710.00
ME 3641 NH 251/108

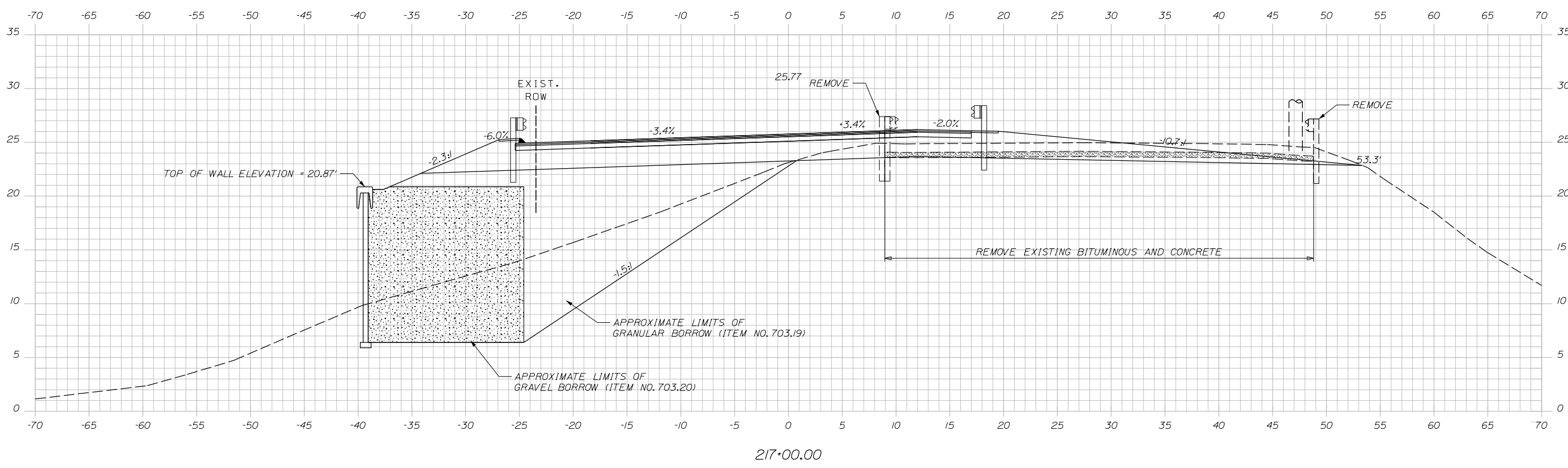
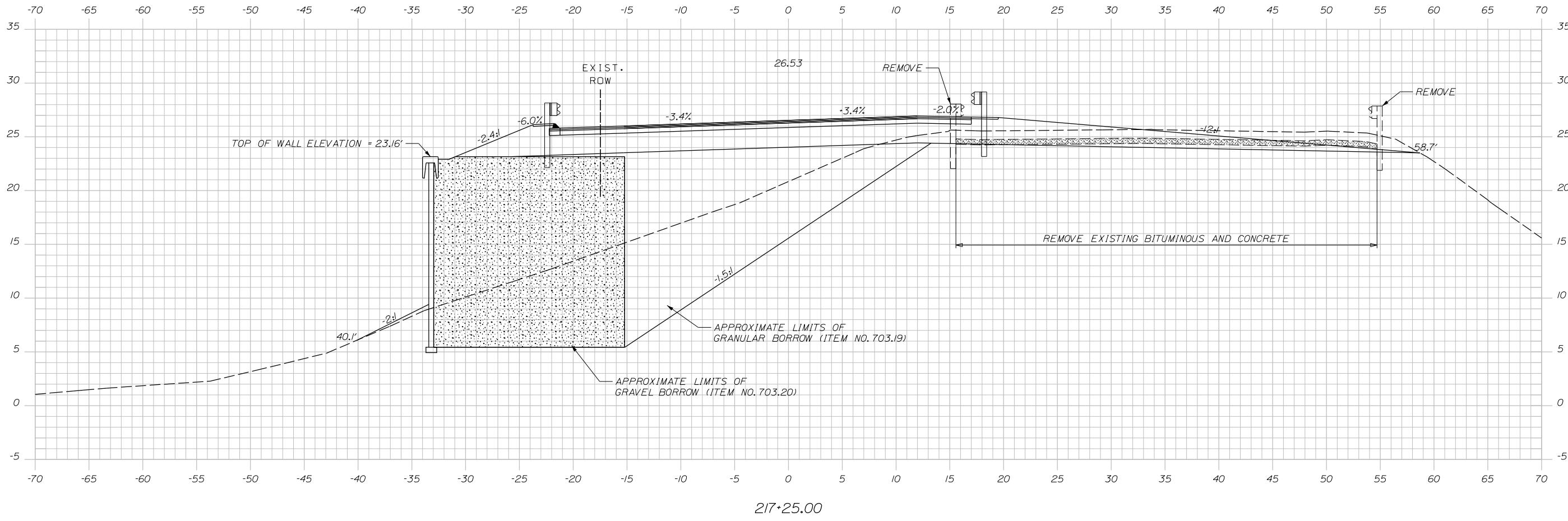

PRELIMINARY - NOT FOR CONSTRUCTION

STATE OF MAINE		DEPARTMENT OF TRANSPORTATION		16710.00	
SARAH MILDRED LONG BRIDGE		PISCATAQUA RIVER		PORTSMOUTH, NH	
KITTEERY, ME		PORTSMOUTH, NH		ROADWAY PLANS	
SHEET NUMBER		R64		OF R104	
PROJ. MANAGER	W. PRALIER	DATE	06-30-14	SIGNATURE	
DESIGN-DETAILED	B. LYON	BY	B. LYON	P.E. NUMBER	
CHECKED-REVIEWED	S. SAWYER	DATE	06-30-14	DATE	
REVISIONS 1					
REVISIONS 2					
REVISIONS 3					
REVISIONS 4					
REVISIONS 5					
REVISIONS 6					
REVISIONS 7					
REVISIONS 8					



100% PLANS (7-3-2014)

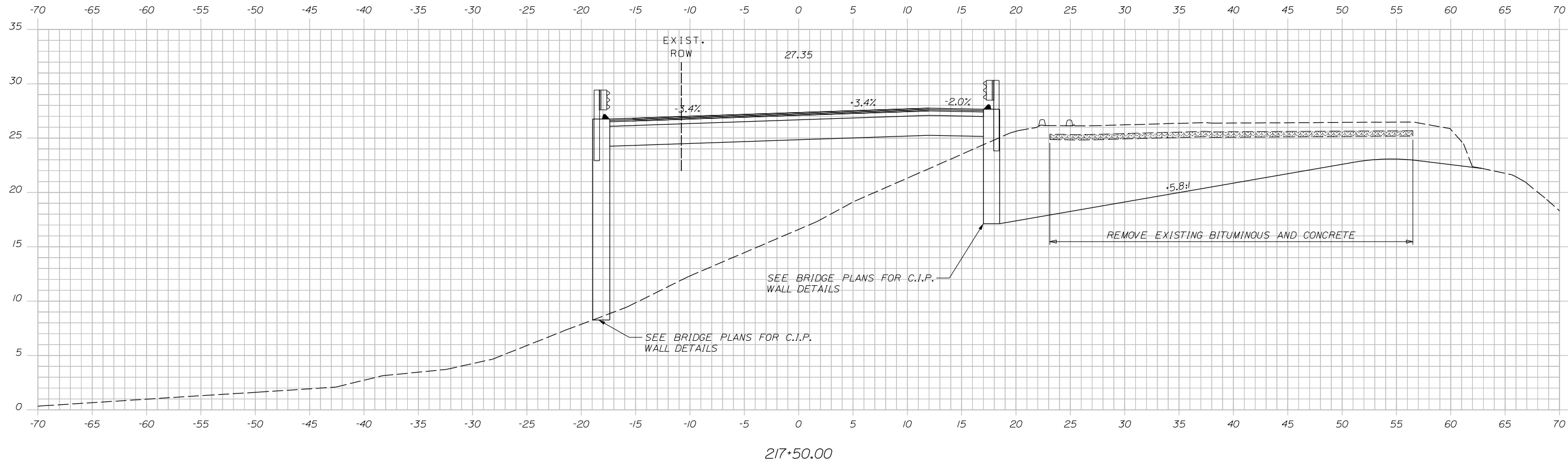

217+50.00

PRELIMINARY - NOT FOR CONSTRUCTION

SARAH MILDRED LONG BRIDGE
PISCATAQUA RIVER
PORTSMOUTH, NH
KITTEERY, ME

SHEET NUMBER

R65

OF R104

PROJ. MANAGER	W. BRADLEE	BY	B. LYON	DATE	06-30-14
DESIGN-DETAILED	B. LYON	CHECKED-REVIEWED	S. SAWYER	DATE	06-30-14
REVISIONS 1				SIGNATURE	
REVISIONS 2				P.E. NUMBER	
REVISIONS 3				DATE	
REVISIONS 4					
REVISIONS 5					
REVISIONS 6					
REVISIONS 7					
REVISIONS 8					

STATE OF MAINE
DEPARTMENT OF TRANSPORTATION
16710.00
PIN
ME 3641 NH 251/108 16710.00
ROADWAY PLANS

